

Helical gear units Horizontal mounting position

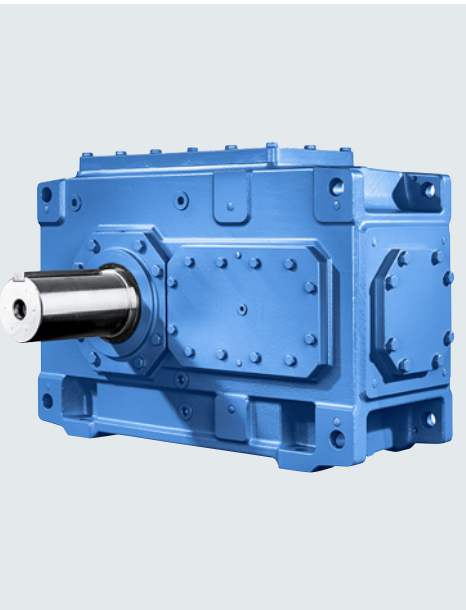

4/2	Type H1
4/2	<u>Gear unit dimensions</u>
4/2	Single-stage, gear unit sizes 3 to 11
4/4	Single-stage, gear unit sizes 13 to 19
4/6	Type H2
4/6	<u>Gear unit dimensions</u>
4/6	Two-stage, gear unit sizes 4 to 8
4/8	Two-stage, gear unit sizes 9 to 12
4/10	Two-stage, gear unit sizes 13 to 18
4/12	Two-stage, gear unit sizes 19 to 24
4/14	Two-stage, gear unit sizes 25 to 28
4/16	Type H3
4/16	<u>Gear unit dimensions</u>
4/16	Three-stage, gear unit sizes 5 to 8
4/18	Three-stage, gear unit sizes 9 to 12
4/20	Three-stage, gear unit sizes 13 to 18
4/22	Three-stage, gear unit sizes 19 to 22
4/24	Three-stage, gear unit sizes 23 to 28
4/26	Type H4
4/26	<u>Gear unit dimensions</u>
4/26	Four-stage, gear unit sizes 7 to 12
4/28	Four-stage, gear unit sizes 13 to 18
4/30	Four-stage, gear unit sizes 19 to 24
4/32	Four-stage, gear unit sizes 25 to 28
4/33	Types H1, H2, H3 and H4
4/33	<u>Article No. overview</u>
4/33	Article No., 10th to 12th position
4/34	Article No., 13th position
4/36	Article No. supplement, 14th position
4/37	Article No. supplement, 15th and 16th position
4/38	Shaft extension on both sides – Gear unit versions G, H and I

Helical gear units horizontal mounting position

Type H1

Gear unit dimensions, single-stage, gear unit sizes 3 to 11

Selection and ordering data

H1.H

2LP302-...30-...

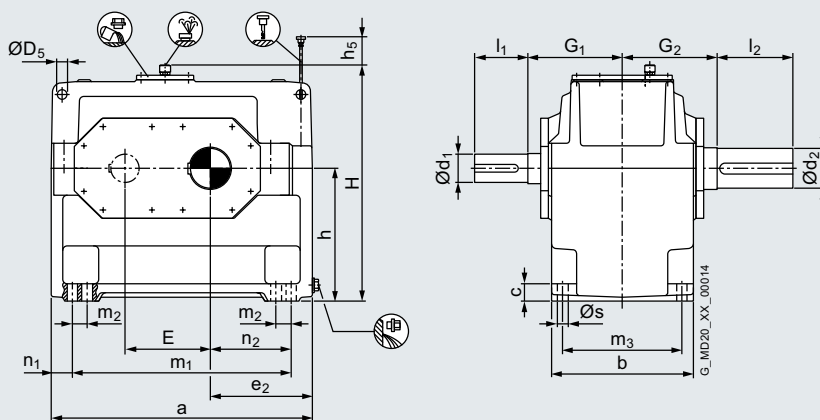

H1.H with fan

2LP302-...30-...

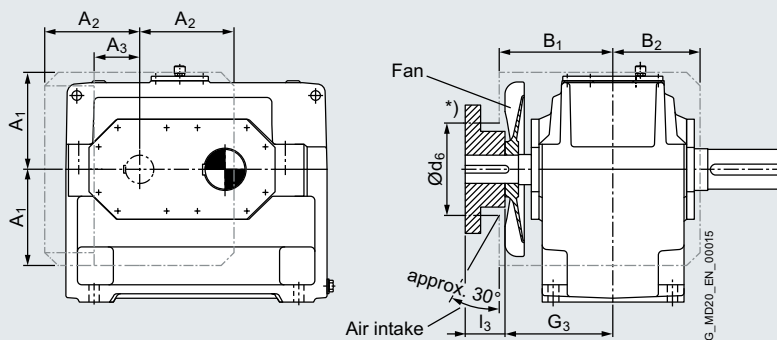

Remove air guide cover before fitting the foundation bolts.

*) For combinations of type H1 gear units with fan and coupling N-EUPEX-A on the high speed shaft, the coupling part 2/3 must be mounted on the motor side.

Gear unit size	Dimensions in mm						Fan					
	i_N	d_1	l_1	l_3	G_1	G_3	A_1	A_2	A_3	B_1	B_2	d_6
3	1.25 - 2.8	60m6	125	105	170	190	150	145	80	205	130	130
	3.15 - 4	45m6	100	80								
	4.5 - 5.6	32m6	80	60								
5	1.25 - 2.8	85m6	160	130	210	240	225	215	115	255	185	190
	3.15 - 4	60m6	135	105								
	4.5 - 5.6	50m6	110	80								
7	1.25 - 2.8	100m6	200	165	250	285	255	250	120	300	230	245
	3.15 - 4	75m6	140	105								
	4.5 - 5.6	60m6	140	105								
9	1.25 - 2.8	110n6	200	165	280	315	300	265	140	330	265	280
	3.15 - 4	90m6	165	130								
	4.5 - 5.6	75m6	140	105								
11	1.6 - 2.8	130n6	240	205	325	360	360	330	190	375	320	350
	3.15 - 4	110n6	205	170								
	4.5 - 5.6	90m6	170	135								

Gear unit size	Dimensions in mm													
	a	b	c	D_5	E	e_2	$h^{1)}$	h_5	H	m_1	m_3	n_1	n_2	s
3	420	200	28	18	130	165	200	85	375	310	160	55	110	19
5	580	285	35	24	185	230	290	100	525	440	240	70	160	24
7	690	375	45	24	225	270	350	75	625	540	315	75	195	28
9	805	425	50	28	265	315	420	50	735	625	350	90	225	35
11	960	515	60	36	320	375	500	40	875	770	440	95	280	35

Shaft seals, see page 10/2 onwards.

¹⁾ Permissible tolerance: -1 mm.

For details on the shafts, see Chapter 9.

Helical gear units horizontal mounting position Type H1

Gear unit dimensions, single-stage, gear unit sizes 3 to 11

Selection and ordering data (continued)

Low speed shaft (LSS)

				Oil quantity ¹⁾ H1.H WDR	Oil quantity ¹⁾ H1.H Labyrinth seal	Weight ^{1) 2)} H1.H	10th to 13th position of Article No. and Article No. supplement, for 14th to 16th position, see pages 4/33 to 4/37		
Article No.:						2LP302	■ - ■ ■ .30-....		
Type	Size	d ₂	l ₂	G ₂	l	l	kg	Solid shaft with parallel key ³⁾	
H1SH	3	60 m6	125	170	7	5.2	128	0 - 2 A	
	5	85 m6	160	210	22	18	302	0 - 4 A	
	7	105 n6	200	250	42	34	547	0 - 6 A	
	9	125 n6	210	270	68	57	862	0 - 8 A	
	11	150 n6	240	320	120	100	1515	1 - 1 A	

Information on type H1:

H1 housings in the version according to the catalog are generally designed as split housings.

Shaft seals, [see page 10/2 onwards](#).

For details on the shafts, [see Chapter 9](#).

Cooling options, [see page 10/11 onwards](#).

¹⁾ Approximate values; exact data acc. to order-related documentation.

²⁾ Without oil filling.

³⁾ Shaft version with reinforced bearing, [see page 9/7](#).

Helical gear units horizontal mounting position

Type H1

Gear unit dimensions, single-stage, gear unit sizes 13 to 19

Selection and ordering data

H1.H

2LP302-...30-....

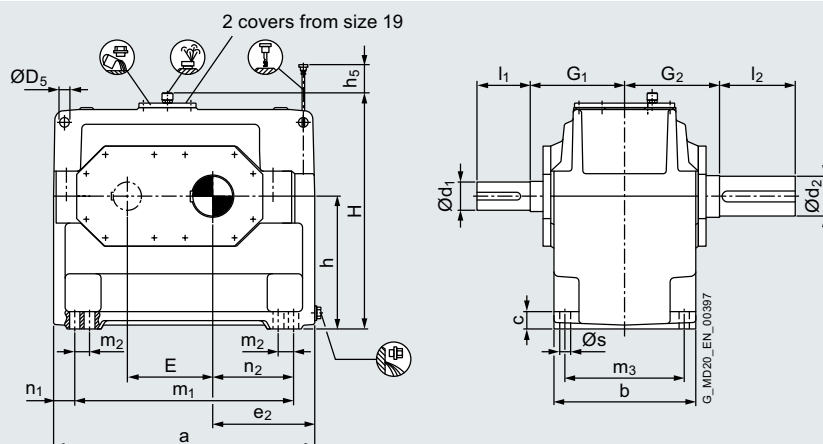

H1.H with fan

2LP302-...30-....

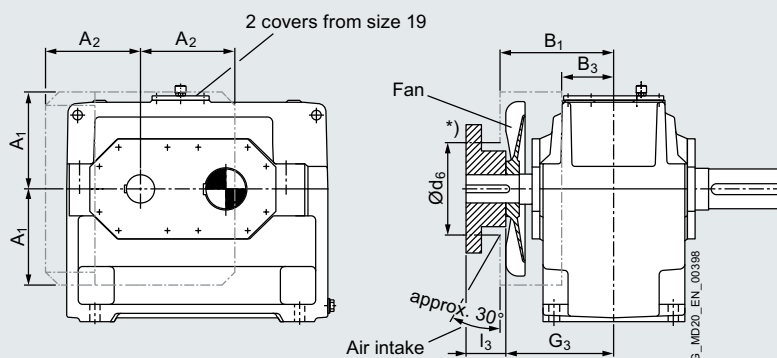

Remove air guide cover before fitting the foundation bolts.

*) For combinations of type H1 gear units with fan and coupling N-EUPEX-A on the high speed shaft, the coupling part 2/3 must be mounted on the motor side.

Gear unit size	Dimensions in mm										
	High speed shaft (HSS)						Fan				
l_N	d_1	l_1	l_3	G_1	G_3	A_1	A_2	B_1	B_3	d_6	
13	1.6 - 2.8	150n6	245	200	365	410	415	350	430	150	350
	3.15 - 4	130n6	245	200							
	4.5 - 5.6	100m6	210	165							
15	2 - 2.8	180n6	290	240	360	410	500	430	430	120	450
	3.15 - 4	150n6	250	200							
	4.5 - 5.6	125n6	250	200							
17	2.8	200n6	330	280	400	450	550	430	470	150	445
	3.15 - 4	170n6	290	240							
	4.5 - 5.6	140n6	250	200							
19	4	190n6	340	290	440	490	630	475	510	190	445
	4.5 - 5.6	160n6	300	250							

Gear unit size	Dimensions in mm														
	a	b	c	D_5	E	e_2	$h^{1)}$	h_5	H	m_1	m_2	m_3	n_1	n_2	s
13	1100	580	70	39	370	430	580	40	1020	870	—	490	115	315	42
15	1295	545	80	48	442	505	600	10	1115	1025	—	450	135	370	48
17	1410	615	80	48	490	545	670	—	1235	1170	130	530	120	425	42
19	1590	690	90	55	555	615	760	—	1395	1290	150	590	150	465	48

Shaft seals, see page 10/2 onwards.

¹⁾ Permissible tolerance: -1 mm.

For details on the shafts, see Chapter 9.

Helical gear units horizontal mounting position Type H1

Gear unit dimensions, single-stage, gear unit sizes 13 to 19

Selection and ordering data (continued)

Low speed shaft (LSS)

				Oil quantity ¹⁾ H1.H WDR	Oil quantity ¹⁾ H1.H Labyrinth seal	Weight ^{1) 2)} H1.H	10th to 13th position of Article No. and Article No. supplement, for 14th to 16th position, see pages 4/33 to 4/37	
Article No.:						2LP302	-	.30-....
Type	Size	d ₂	l ₂	G ₂	l	l	kg	Solid shaft with parallel key ³⁾
H1SH	13	180 n6	310	360	175	155	2395	1 - 3 A
	15	220 n6	350	360	190	156	3200	1 - 5 A
	17	240 n6	400	400	270	225	4250	1 - 7 A
	19	270 n6	450	440	390	330	5800	2 - 0 A

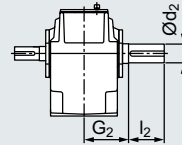

Information on type H1:

H1 housings in the version according to the catalog are generally designed as split housings.

Shaft seals, [see page 10/2 onwards](#).

For details on the shafts, [see Chapter 9](#).

Cooling options, [see page 10/11 onwards](#).

¹⁾ Approximate values; exact data acc. to order-related documentation.

²⁾ Without oil filling.

³⁾ Shaft version with reinforced bearing, [see page 9/7](#).